

STUCCO AND STONE VENEER ON WOOD FRAME STRUCTURES

When making an application for a siding permit, which includes stucco or stone veneer application as part of the project, information to verify code compliance should be included with submittal documents. A lathing installation inspection is required prior to installing the stucco base coat.

Weather-Resistive Barrier

Over wood based sheathing, 2 layers of Grade "D" building paper are required. The building paper must be lapped shingle style with the vertical joints lapped a minimum of 6 inches and the horizontal joints lapped a minimum of 2 inches. The building paper must also be continuous to the under side of rafter or truss top cord. Type 15 or 15# felt is not grade D paper (R703.7.3)

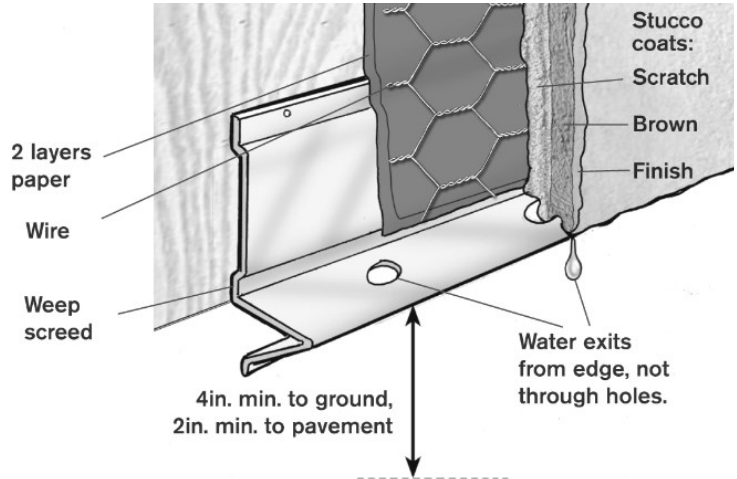

Metal Lath

All lath and lath attachments shall be of corrosion resistant materials. Expanded metal lath or woven wire lath shall be attached with 11 gauge nails having a 7/16 inch head or 16 gauge staples, spaced no more than 6 inches at supports. Nails or staples shall penetrate wood framing support members a minimum of ¾ inches. Lath is to be installed with long dimension at a right angle to framing. Lath must be lapped ½ inch at sides and 1 inch at ends. The ends of lath are to be staggered. Corner beads shall be installed to protect all external corners and to establish grounds. Where no corner bead is used, lath shall be furred out and carried around corners at least one support on frame construction. A lathing installation inspection is required prior to installing the stucco base coat. (R703.7.1)

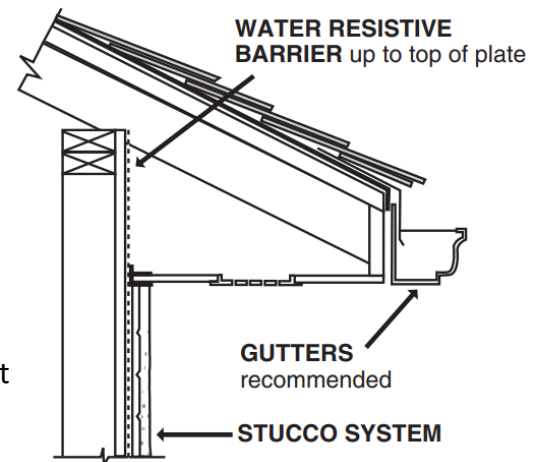

Weep Screed

A minimum 0.019" (No.26 galvanized sheet gauge) corrosion-resistant weep screed with a minimum vertical attachment flange of 3½ inches shall be provided at or below the foundation plate line on all exterior stud walls. The weep screed shall be placed a minimum of 4 inches above the earth or 2 inches above paved areas and shall be of a type that will allow trapped water to drain to the exterior of the building. The weather-resistant barrier shall lap the attachment flange. The exterior lath shall cover and terminate on the attachment flange of the weep screed. (R703.2.1)

Weep screed
(typical)

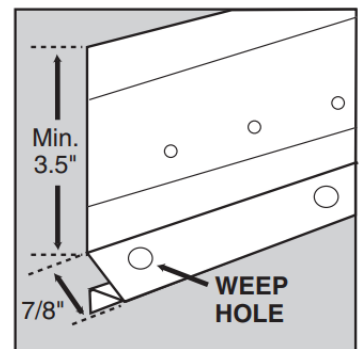

Casing Bead

Non-load bearing members shall be isolated from load bearing members, and all penetrating elements, with casing beads or other suitable means, to avoid transfer of structural loads and to separate dissimilar materials. Casing bead is to be installed $\frac{3}{8}$ inch away from window frames.

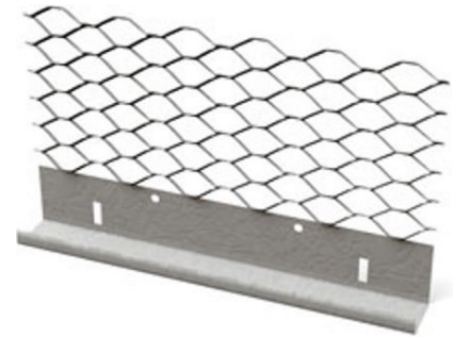

Flashing

Approved corrosion-resistive flashing is required at the top of all exterior windows and door openings, continuously above all projecting wood trim and at all wall/roof intersections. "Kick out" style flashing is to be installed at wall/roof intersections where the roofline does not extend past the wall. . (R703.4 & R903.2.1.1)

