

LEGEND

- INPLACE ROADWAY
- █ PROPOSED CONSTRUCTION

ANOKA COUNTY HIGHWAY DEPARTMENT

TYPICAL LEFT TURN LANE
(USE PAVEMENT SECTION ADT > 10,000 IN DETAIL "A")

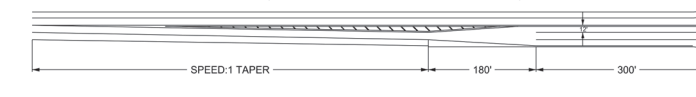

TYPICAL BY-PASS
(USE PAVEMENT SECTION ADT > 10,000 IN DETAIL "A")

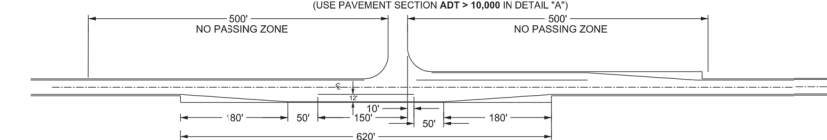

TYPICAL RIGHT TURN LANE

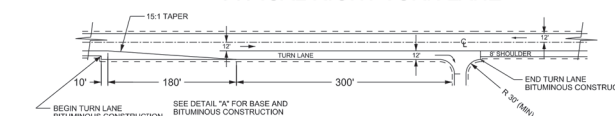

ALL DISTURBED SOIL MUST BE SEED, MULCH, AND DISK ANCHORED IN ACCORDANCE WITH MNDOT STANDARD SPECIFICATIONS. RAPID-DEGRADABLE STRAW BLANKET SHALL BE USED IN AREAS OF HIGH EROSION.



Turn/Bypass Lane Addition
On Existing Highway

NOT TO SCALE
EXHIBIT 1
January 2020

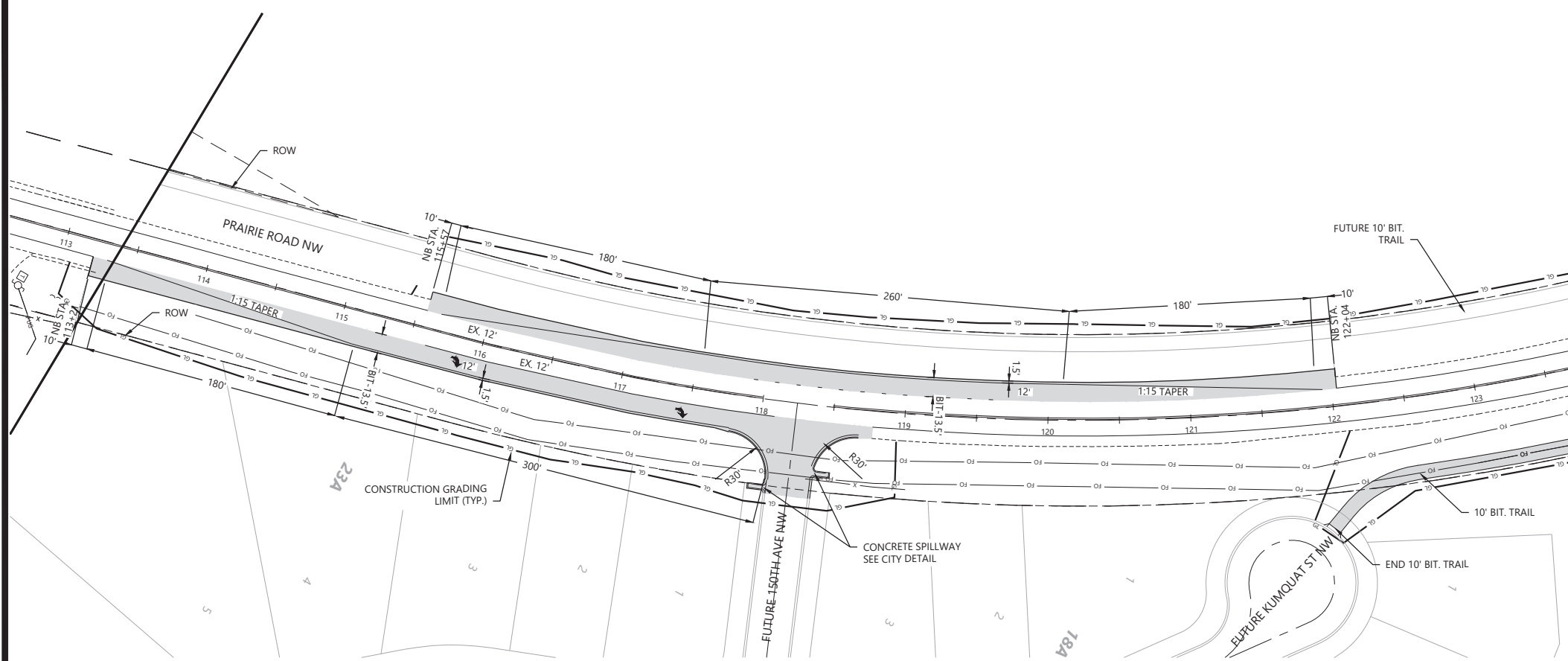

GENERAL SITE NOTES

- BACKGROUND INFORMATION FOR THIS PROJECT PROVIDED BY WESTWOOD PROFESSIONAL SERVICES, INC.
- LOCATIONS AND ELEVATIONS OF EXISTING TOPOGRAPHY AND UTILITIES AS SHOWN ON THIS PLAN ARE APPROXIMATE. CONTRACTOR SHALL FIELD VERIFY SITE CONDITIONS AND UTILITY LOCATIONS PRIOR TO EXCAVATION/CONSTRUCTION. IF ANY DISCREPANCIES ARE FOUND, THE ENGINEER SHOULD BE NOTIFIED IMMEDIATELY.
- THE CONTRACTOR SHALL BE RESPONSIBLE FOR PROVIDING AND MAINTAINING TRAFFIC CONTROL DEVICES SUCH AS BARRICADES, WARNING SIGNS, DIRECTIONAL SIGNS, FLAGGERS AND LIGHTS TO CONTROL THE MOVEMENT OF TRAFFIC WHERE NECESSARY. PLACEMENT OF THESE DEVICES SHALL BE APPROVED BY THE CITY AND ENGINEER PRIOR TO PLACEMENT. TRAFFIC CONTROL DEVICES SHALL CONFORM TO APPROPRIATE MNDOT STANDARDS.
- BITUMINOUS PAVEMENT AND CONCRETE SECTIONS TO BE IN ACCORDANCE WITH THE RECOMMENDATIONS OF THE GEOTECHNICAL ENGINEER.
- CONTRACTOR SHALL MAINTAIN FULL ACCESS TO ADJACENT PROPERTIES DURING CONSTRUCTION AND TAKE ALL PRECAUTIONS NECESSARY TO AVOID PROPERTY DAMAGE TO ADJACENT PROPERTIES.

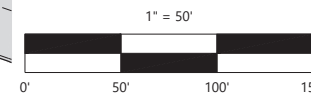
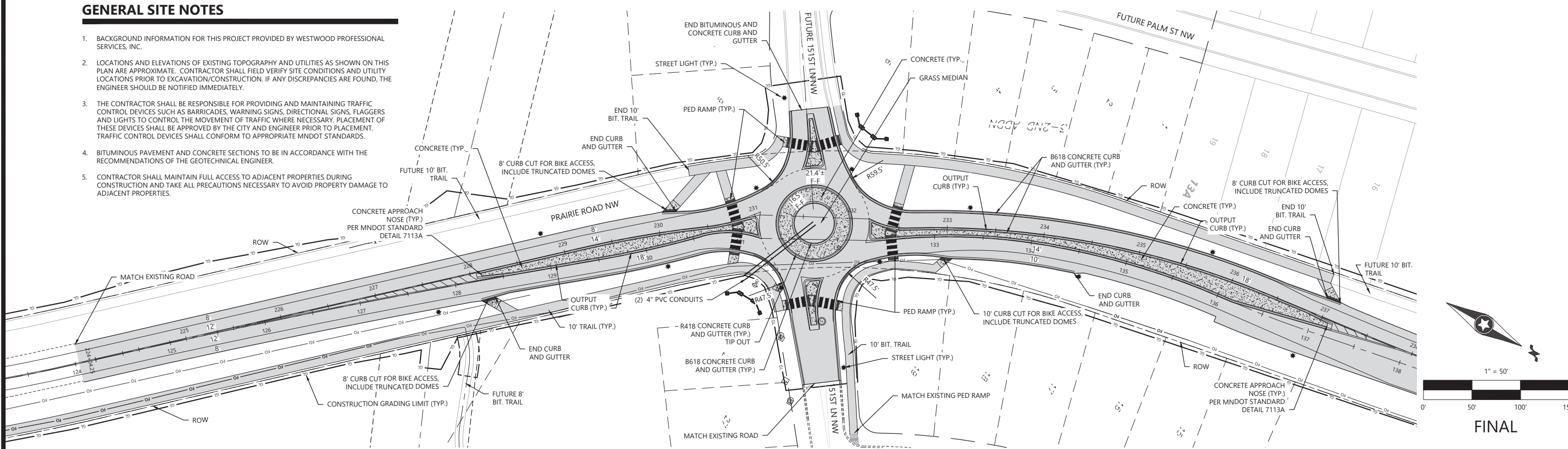

FINAL

DESIGNED:	CHF
CHECKED:	CHF
DRAWN:	DJW
HORIZONTAL SCALE:	50'
VERTICAL SCALE:	

INITIAL ISSUE:	02/24/23
REVISIONS:	
▲	05/17/23 CITY COMMENTS REVISION
▲	06/13/23 CITY COMMENTS REVISION
▲	06/21/23 CITY COMMENTS REVISION
▲	
▲	

PREPARED FOR:
LENNAR HOMES
16305 36TH AVENUE NORTH, SUITE 600
PLYMOUTH, MINNESOTA 55446

I HEREBY CERTIFY THAT THIS PLAN WAS PREPARED BY ME OR UNDER MY DIRECT SUPERVISION AND THAT I AM A DULY LICENSED PROFESSIONAL ENGINEER UNDER THE LAWS OF THE STATE OF MINNESOTA.
Christian H. Froemke
CHRISTIAN H. FROEMKE
DATE: 06/21/23 LICENSE NO. 56208

FIELDS OF WINSLOW COVE
PRAIRIE ROAD IMPROVEMENTS
ANDOVER, MN

Westwood
Phone (952) 937-5150 12701 Whitewater Drive, Suite #300
Fax (952) 937-5822 Minnetonka, MN 55343
Toll Free (888) 937-5150 westwoodps.com
Westwood Professional Services, Inc.

SHEET NUMBER:
31 OF **84**
CONSTRUCTION PLAN
PROJECT NUMBER: 0028734.00 DATE: 06/21/23

FIELDS OF WINSLOW COVE PRAIRIE ROAD IMPROVEMENTS